

EX650A6F Installation Instructions for Cowling Panel Vibration Damper Kit (99999-0093)

1, Remove the following in order:

Windshield

Belly Pan (Both Halves)

Cowling Upper Trim Panels

Meter Cover

Rear View Mirrors

Upper Cowling (After disconnecting the turn signal wires and headlamp connectors)

Main cowling inner panels left and right side

Headlight Assembly

2, Using the following photos as a guideline, install the foam dampers in the positions indicated:

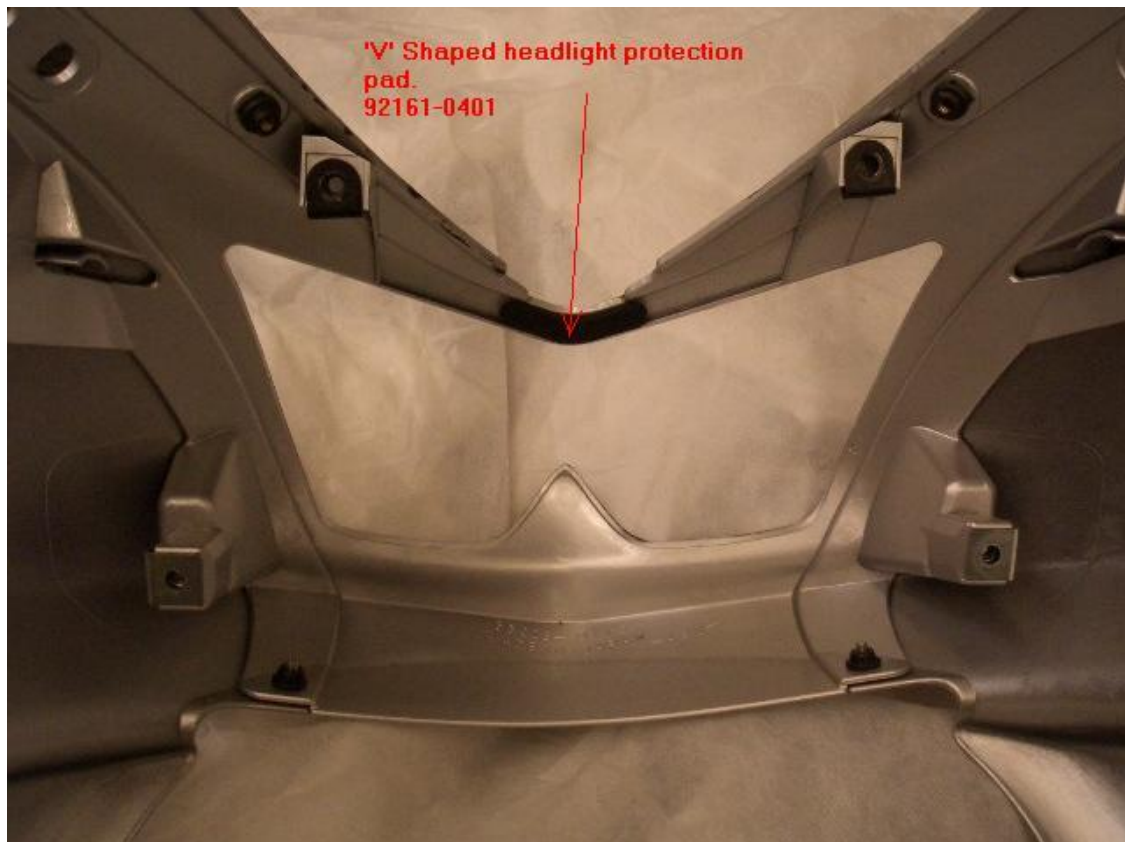

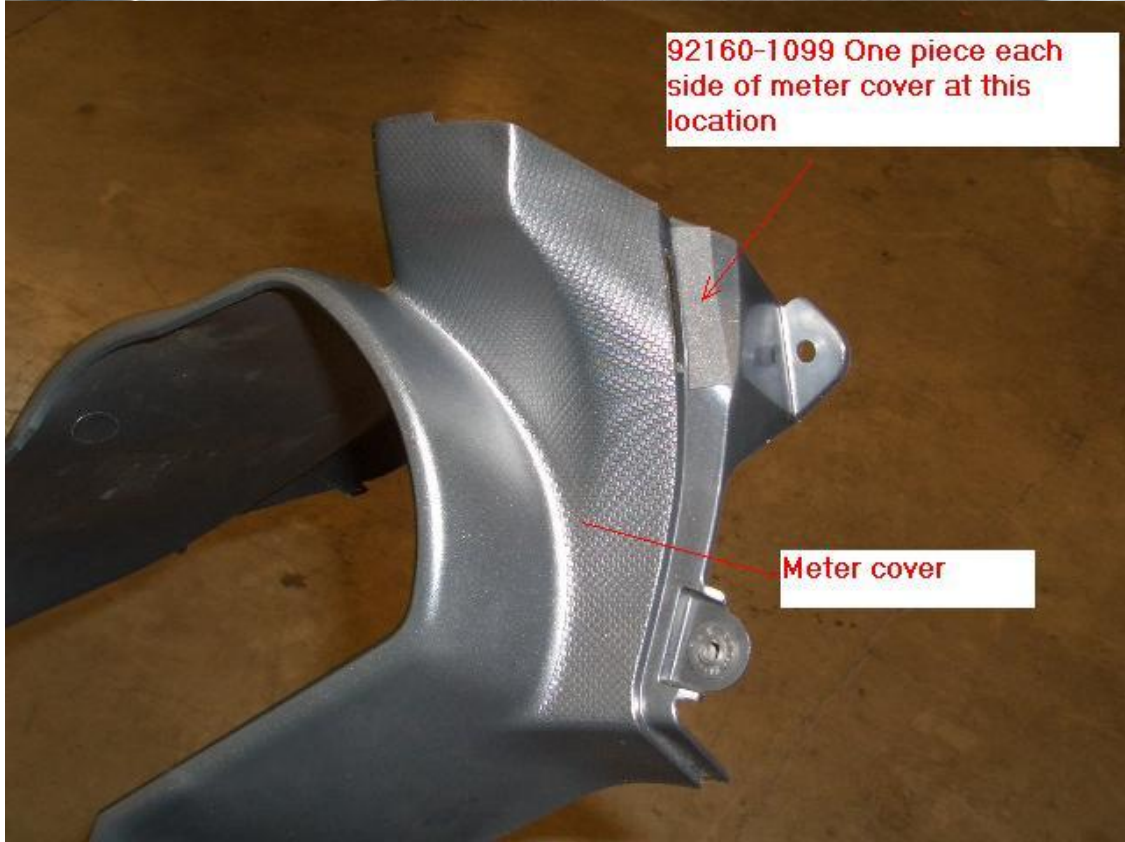
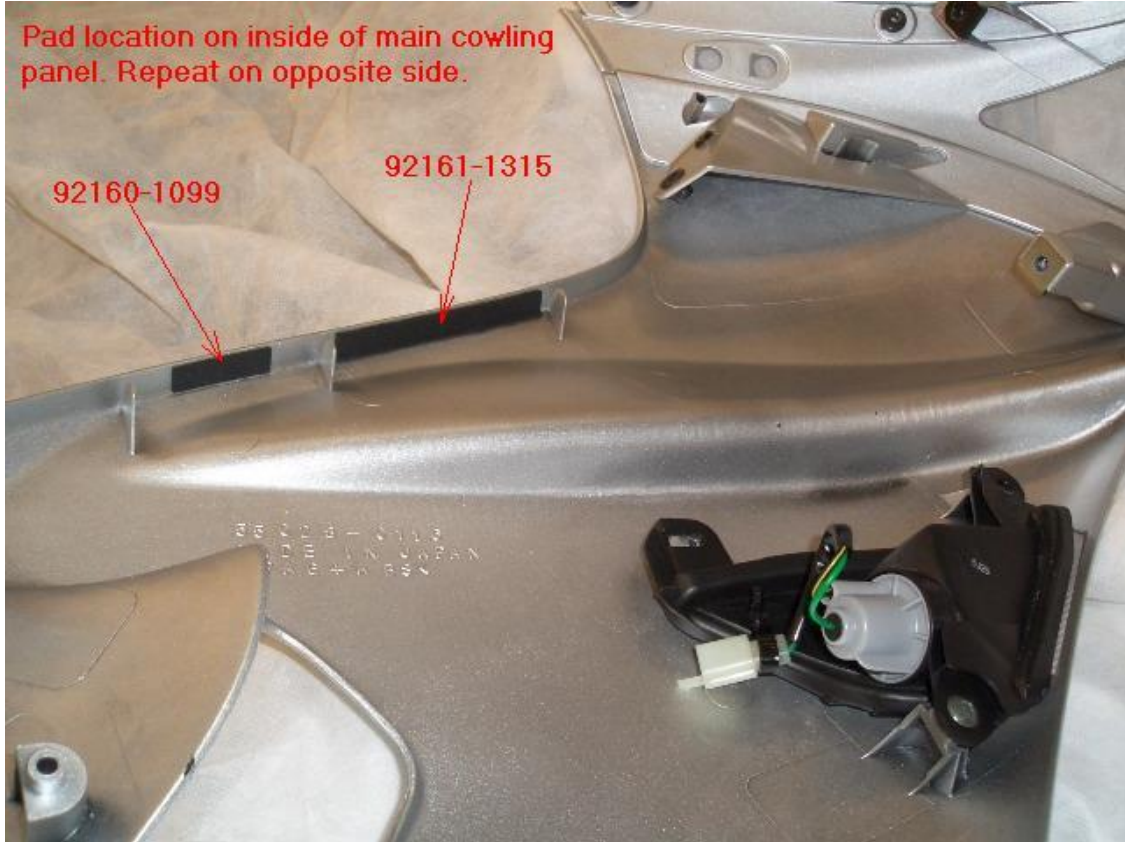

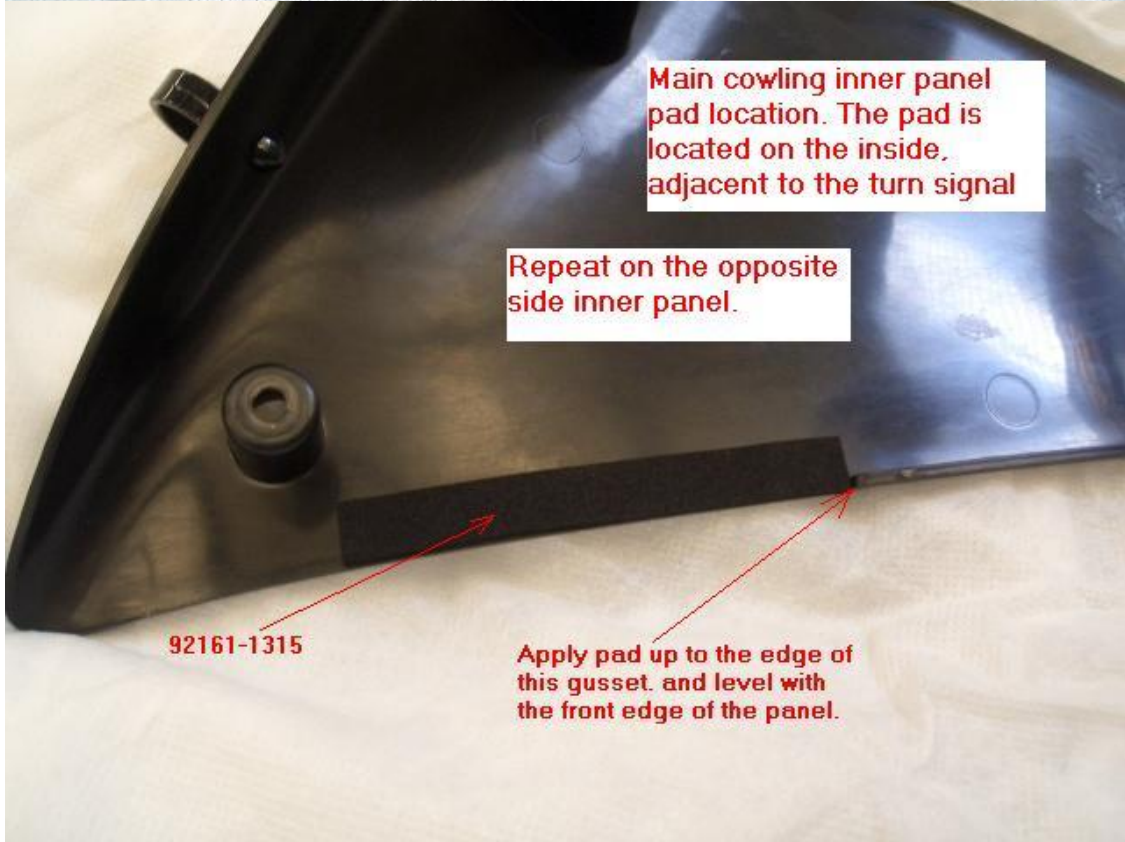



3, Re-assemble the cowling in the reverse order of disassembly. Use caution when tightening inner panel screws and headlight bolts. The cowling brackets are thin and can break easily.